



AIR CONTROL SOLUTIONS

THE NELSON ACV200 PROVIDES ALL THREE TYPES OF AIR RELIEF: AIR RELIEF, VACUUM AIR RELIEF, AND CONTINUOUS AIR RELEASE UNDER PRESSURE.

9672-004 (BSP); 9672-003 (NPT)

IMPROVED DESIGN

REINFORCED SEAL PREVENTS MISALIGNMENT

IMPROVED AIR SEPARATION TO REDUCE DRIPS DURING AIR RELEASE

NEW MATERIAL RESISTANT TO PUMP LUBRICANTS

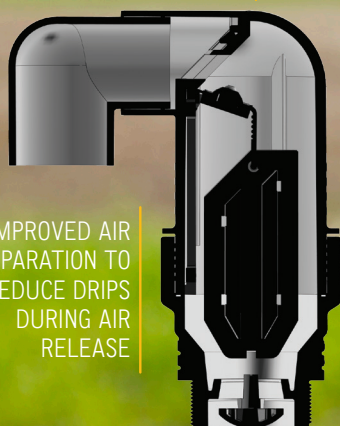

Pump start-up high capacity air venting.

Pump shut-off vacuum relief.

Filter backflush.

Vent at high points.

Continuous air release during system operation.

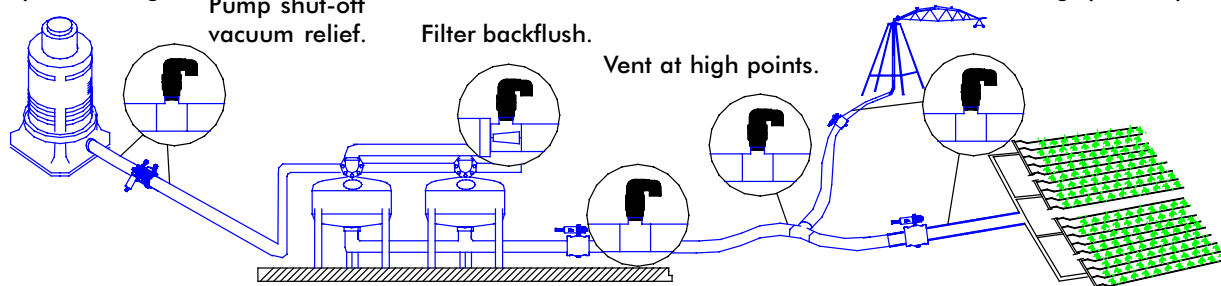

Performance Graph

Figure 6

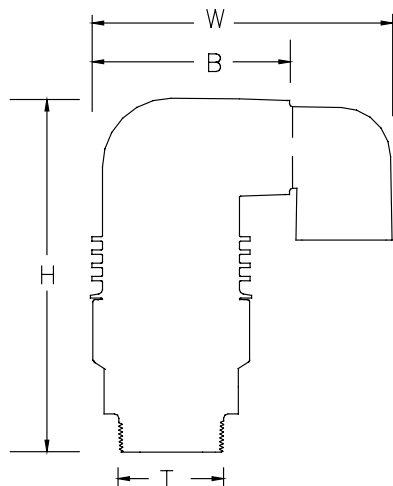
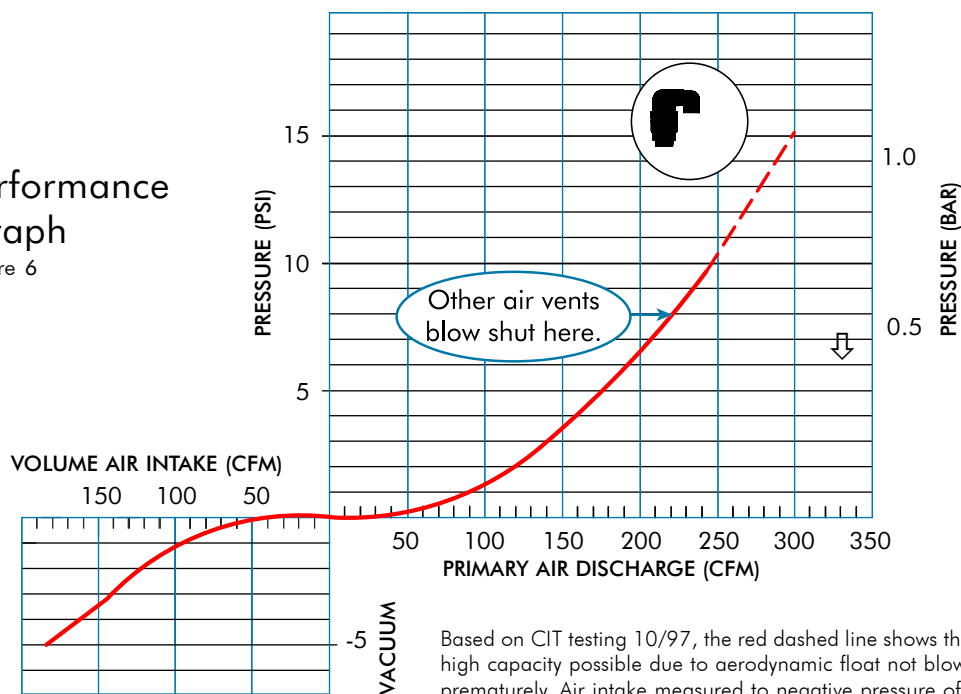

MATERIALS

Body	Glass filled Nylon
Elbow	Glass filled Polypropylene
Base: ACV200B	Brass=CDA 844 ASTM B145-5A Federal QQ-C390, Alloy B2
Base: ACV200P	Plastic=Glass filled Polypropylene
Float	Polypropylene
Vent Seal	EPDM (#304 stainless steel reinforcement)
Seal ('O'ring)	BUNA-N

DIMENSIONS

	Brass		Plastic	
	in	mm	in	mm
H	8.03	204	8.52	216
W	6.85	174	6.85	174
B	4.45	113	4.45	113
T	2 in. male NPT or BSP			