



800 Series Pressure Control Pilot

Service Kit Installation

Service Kits

Part #	Description
12229-004	Small Body Pilot Service Kit
12230-004	Large Body Pilot Service Kit

New internal parts of the pressure control pilots were put into production beginning 1/1/2014. The internal parts in pre-2014 pilots cannot be serviced without first being rebuilt using the corresponding upgrade kit. Service kits are available to rebuild pilots manufactured or upgraded after 1/1/2014.

Small Body Pilot Service Kit
for 2" & 3" valves

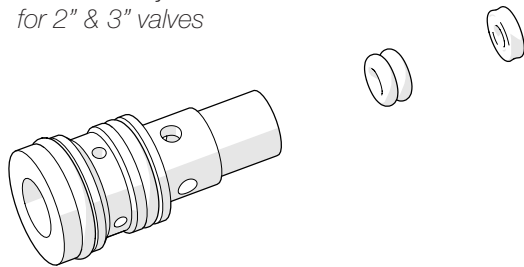

Large Body Pilot Service Kit
for 4", 6" and 8" valves

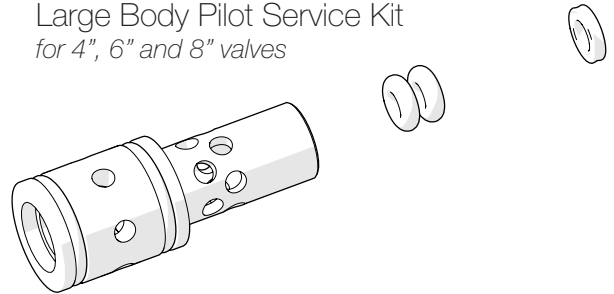

Service Kit Installation Instructions

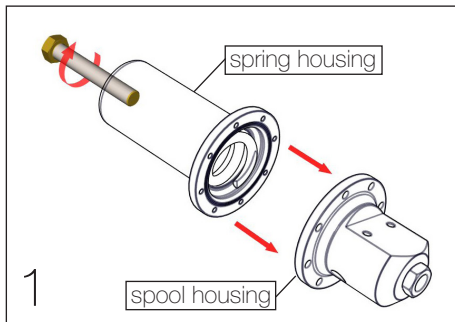

1
Back-off adjustment screw to remove pressure from the spring. Separate spring housing from spool housing.

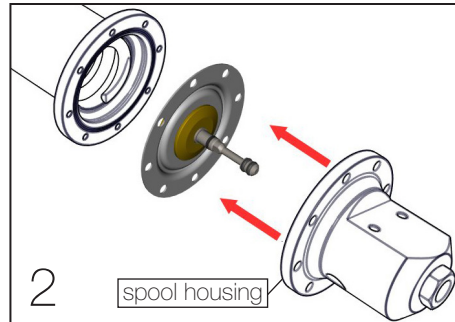

2
Remove spool assembly from spool housing.

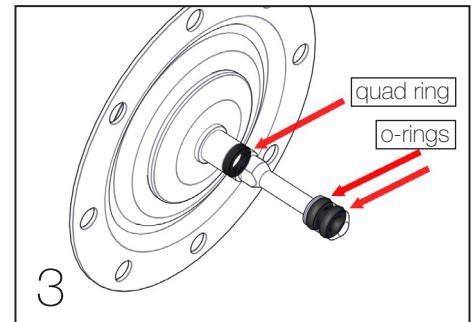

3
Replace o-rings and quad ring on spool.

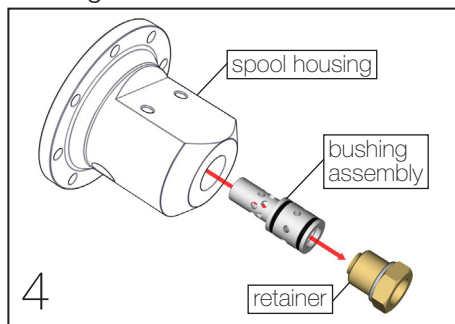

4
Remove existing bushing assembly. Separate the retainer from the bushing assembly.

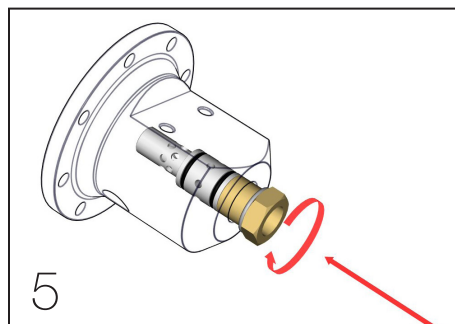

5
Install the new bushing assembly in the spool housing. Thread-in the retainer.

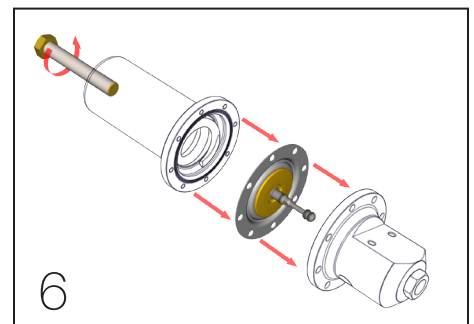

6
Install the spool assembly in spool housing. Re-assemble the spool housing and the spring housing. Set the adjustment screw to the desired pressure set point.